

Twin Diaphragm Vacuum Pumps

N 035.1 ---
N 035.3 ---

P portable models / **I** installation models

	N 035.1 AN	N 035.3 AN
Flow Capacity:	2.2 scfm	1.15 scfm
Max. Vacuum:	27 in. Hg	29.5 in. Hg

.1 heads in parallel
.3 2-stage



Pump Materials:

N 035 AN	Aluminum/Neoprene
N 035 AV ⁽¹⁾	Aluminum/Viton
N 035 AT ⁽²⁾	Aluminum/Teflon®
N 035 SN	Stainless Steel/Neoprene
N 035 SV ⁽¹⁾	Stainless Steel/Viton
N 035 ST ⁽²⁾	Stainless Steel/Teflon®
N 035 TN	PVDF Coated/Neoprene
N 035 TV ⁽¹⁾	PVDF Coated/Viton
N 035 TT ⁽²⁾	PVDF Coated/Teflon®

KNF Features

- 100% oil-free operation
- contamination-free pumping of air, gas, or vapor
- low noise operation
- minimum vibration
- corrosion-resistant versions - see KNF Type-Chart
- oversized bearings for long life
- trouble-free operation in any position
- diaphragm and valve plate changed easily in just minutes
- available with TEFC (IP-44) motor

Dimensions: (inches)

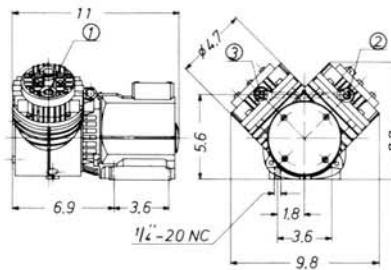

Port Connections	N 035.1	N 035.3
NPT 1/4" ①	Inlet	Closed
NPT 1/4" ②	Outlet	Inlet
NPT 1/4" ③	Outlet	Outlet

Technical Data:

Max. ambient operating temperature 105° F (40° C).
115 V, 60 Hz shaded pole electric motor (std.).
Current draw at max. load: 6.3 amps
Weight: 26 Lbs

Accessories:

Hose connector
Muffler

Performance Characteristics

