

# NF 300 DIAPHRAGM LIQUID PUMP



## ADVANTAGES

- Self priming and excellent for pressure
- Extreme chemical resistance
- Dry running and durable
- Low maintenance
- Available with integrated overpressure relief valve (version .27)

## POSSIBLE AREAS OF USE

- Analysers
- Laboratory
- Cleaning industry
- Printing

Please visit our website  
[www.knf.com](http://www.knf.com)  
to get more information.

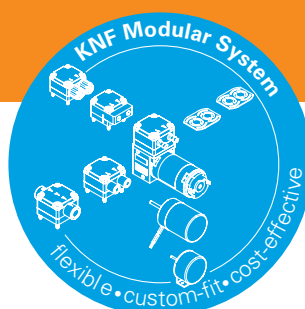

PERFORMANCE DATA					
Series model	NF 300 DC				NF 300 DCB*
Material options	KP	KT	TT	FT	
Pump head	PP	PP	PVDF	PTFE	
Diaphragm	PTFE	PTFE	PTFE	PTFE	
Valves	EPDM	FFKM	FFKM	FFKM	
Flow rate at atm. pressure (l/min)	3				
Suction height (mWg)	3				
Pressure head (mWg)	10				
Permissible ambient air (°C)	5 to 40				
Permissible liquid temperature (°C)	5 to 80				
Weight (kg)	1				1
IP protection factor pump	50				54
ELECTRICAL DATA					
Operating voltage (V)	12 / 24				12 / 24
Power consumption (W)	20 / 20				25.2 / 28.8
I load max. (A)	1.6 / 0.8				2.1 / 1.2

\* DCB = Stands for brushless DC motor

# NF 300 DC

## PERFORMANCE DATA

Series model	Flow rate at atm. pressure (l/min)	Max. suction height (mWg)	Max. pressure head (mWg)
NF 300 DC	3	3	10

## NF 300 DC

NF 300\_\_27 DC  
UNF 300\_\_27 DC

NF 300\_\_DC  
UNF 300\_\_DC

*
NF 300 G3/8"
UNF 300 NPT3/8"

Dimensions in mm

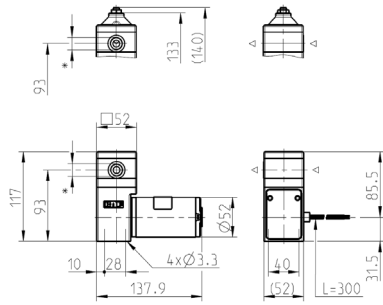

# NF 300 DCB

## PERFORMANCE DATA

Series model	Flow rate at atm. pressure (l/min)	Max. suction height (mWg)	Max. pressure head (mWg)
NF 300 DCB	3	3	10

## NF 300 DCB

NF 300\_\_27 DCB  
UNF 300\_\_27 DCB

NF 300\_\_DCB  
UNF 300\_\_DCB

*
NF 300 G3/8"
UNF 300 NPT3/8"

Dimensions in mm

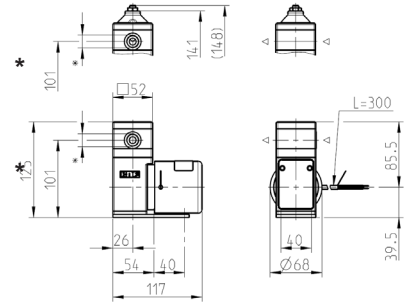

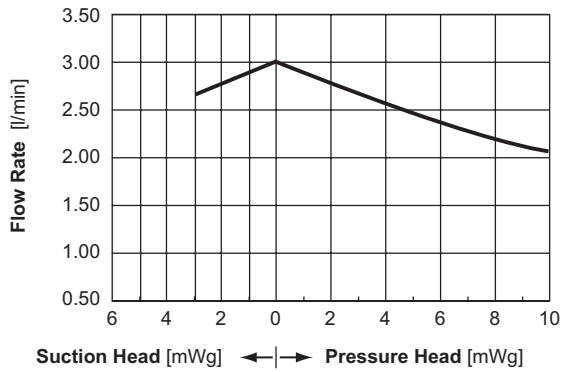

## NF 300 DC FLOW CURVE

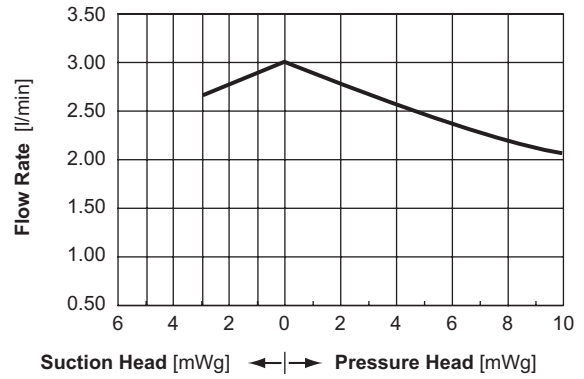

## NF 300 DCB FLOW CURVE

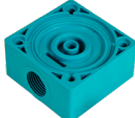

OPTIONS		
Description	Illustration	Details
Motors		Various voltage options, higher and lower service life
Electrical connections		Molex, AMP etc.
Hydraulic connections		G / NPT internal thread



### NSF National Sanitary Foundation

This certification confirms that all of the pumps with the code .51 are certified for the use with foods/consumables.

ACCESSORIES			
Description	Illustration	Part No.	Details
Diaphragm pressure control valve (version .27)		On request	The pressure control valve can be used for a more accurate control of flow against a fluctuating back pressure, metering into a vacuum and from a pressurised system.
Pulsation damper		KP: 068893/152351 KT: 068894/152351 TT: 068895/152352	This very versatile pulsation damper reduces the vibration in hoses and pipes and it helps to remove pulsation which is preventing the system from functioning correctly.
Hose Connector		168549	Straight hose barb suitable for lower pressures. Connection: DN 12 Material: ETFE O-Ring: EPDM Thread: NPT 3/8"
Hose Connector		168551	Straight hose barb suitable for lower pressures. Connection: DN 12 Material: ETFE O-Ring: FFKM Thread: NPT 3/8"

The performance values for the series models shown on this data sheet were determined under test conditions. The actual performance values may differ and depend in particular on the usage conditions and therefore on the specific application, on the parameters of the components involved in the user's system and on any technical modifications carried out which deviate from the standard configuration or the as delivered condition.

If individual designs have been created for specific customers on the basis of series models, other technical performance data may apply. Before operation begins, the relevant operating instructions and/or assembly or installation instructions should be read and the safety information contained in these instructions should be noted. KNF reserves the right to make changes to the product and the associated documentation without prior notice to the customer.



[www.knf.com](http://www.knf.com)

KNF reserves the right to make technical changes without notice.  
KNF 01/2023. [www.knf.com](http://www.knf.com)