

# NMP015.1.2 SERIES MICRO DIAPHRAGM GAS PUMPS



NMP0151.2XPDC-S



NMP015.1.2XPDC-M



NMP015.1.2XPDC-L

## ADVANTAGES

- Customizing available
- Tested to customers specs
- High performance to size, efficiency and weight ratio
- Excellent reliability/durability
- Speed controllable
- Low sound level
- Long service life
- Uncontaminated transfer
- Maintenance-free
- High chemical resistance
- Can be installed in any position

## POSSIBLE AREAS OF USE

- Medical devices
- Analytical equipment
- Emission measurement
- Reprographic
- Degassing
- Safety/Security
- Portable devices

Please visit our website  
[www.knf.com](http://www.knf.com)  
to get more information.

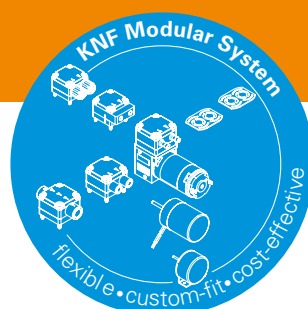

## PERFORMANCE DATA

Series Model	NMP015.1.2											
Material design	XPDC-S		XPDC-M		XPDC-L		XPDC-B		XTDC-L		XTDC-B	
Pump head	PEEK											
Diaphragm	EPDM						PTFE coated					
Valves	EPDM/FKM						FFPM/FKM					
Flow rate at atm. pressure (l/min)	1.6	2.2	1.8	1.9	1.9	1.9	1.4	1.5				
Ultimate vacuum (mbar abs.)	600	700	600		600	600	650	650				
Ultimate pressure (bar rel)	0.6	0.4	0.55		0.6	0.6	0.5	0.5				
Permissible media and ambient temperature (°C/°F)	+5° C to +40° C / 41° F to 104° F (-20° C to +60° C / -4° F to 140° F on request)											
Weight (g/oz)	50/1.76	92/3.25	60/2.12		55/1.94	60/2.12	55/1.94					

## ELECTRICAL DATA

Voltage (V)	6	6	12	6	12	6	12	6	12	6	12	
Motor	DC		DC		DC		Brushless DC		DC		Brushless DC	
I <sub>max</sub> (A)	0.44	0.35	0.18	0.36	0.18	0.35	0.18	0.4	0.2	0.39	0.22	

# NMP015.1.2XPDC-S

## PERFORMANCE DATA

Series model	Flow rate at atm. pressure (l/min)	Max. operating pressure (bar rel)	Ultimate vacuum (mbar abs.)
NMP015.1.2XPDC-S 6V	1.6	0.6	600

## NMP015.1.2XPDC-S

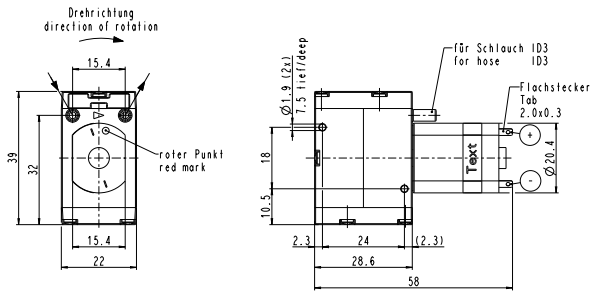

Dimensions in mm

# NMP015.1.2XPDC-M

## PERFORMANCE DATA

Series model	Flow rate at atm. pressure (l/min)	Max. operating pressure (bar rel)	Ultimate vacuum (mbar abs.)
NMP015.1.2XPDC-M 6V	2.2	0.4	700
NMP015.1.2XPDC-M 12V	2.2	0.4	700

## NMP015.1.2XPDC-M

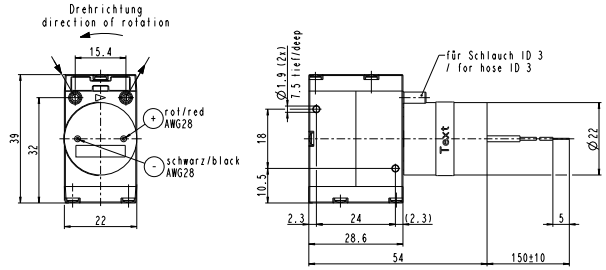

Dimensions in mm

## NMP015.1.2XPDC-S 6V FLOW CURVE

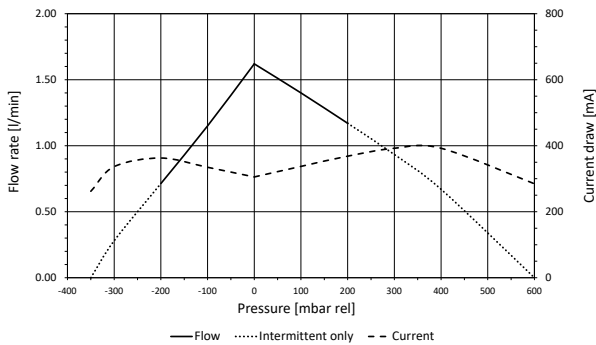

## NMP015.1.2XPDC-M 6V FLOW CURVE

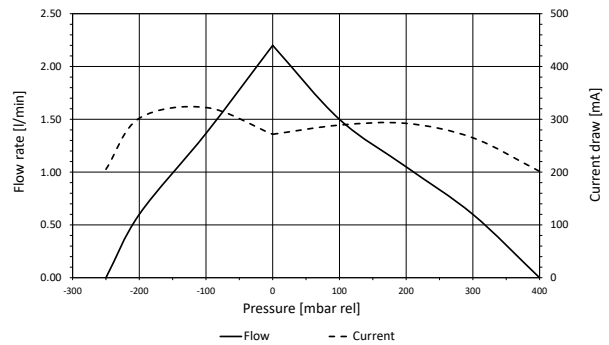

## NMP015.1.2XPDC-M 12V FLOW CURVE

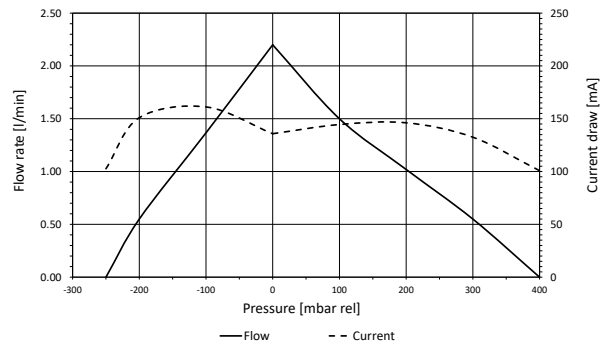

# NMP015.1.2XPDC-L

## PERFORMANCE DATA

Series model	Flow rate at atm. pressure (l/min)	Max. operating pressure (bar rel)	Ultimate vacuum (mbar abs.)
NMP015.1.2XPDC-L 6V	1.8	0.55	600
NMP015.1.2XPDC-L 12V	1.9	0.55	600

## NMP015.1.2XPDC-L

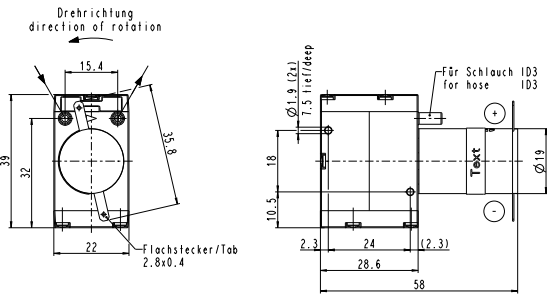

Dimensions in mm

# NMP015.1.2XPDC-B

## PERFORMANCE DATA

Series model	Flow rate at atm. pressure (l/min)	Max. operating pressure (bar rel)	Ultimate vacuum (mbar abs.)
NMP015.1.2XPDC-B 6V	1.9	0.6	600
NMP015.1.2XPDC-B 12V	1.9	0.6	600

## NMP015.1.2XPDC-B

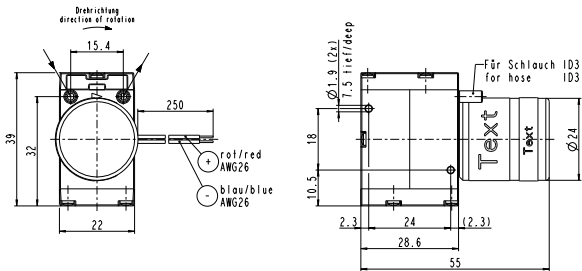

Dimensions in mm

## NMP015.1.2XPDC-L 6V FLOW CURVE

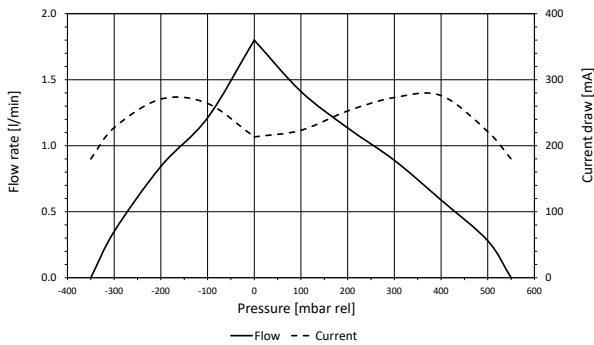

## NMP015.1.2XPDC-B 6V FLOW CURVE

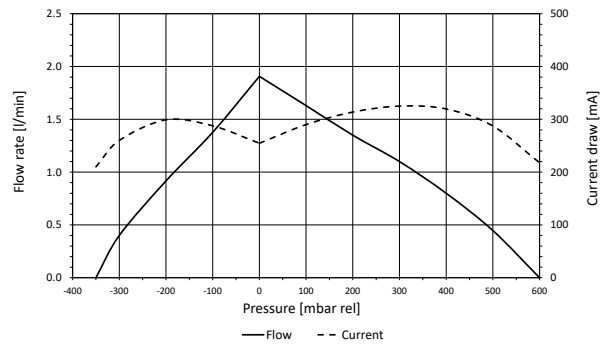

## NMP015.1.2XPDC-L 12V FLOW CURVE

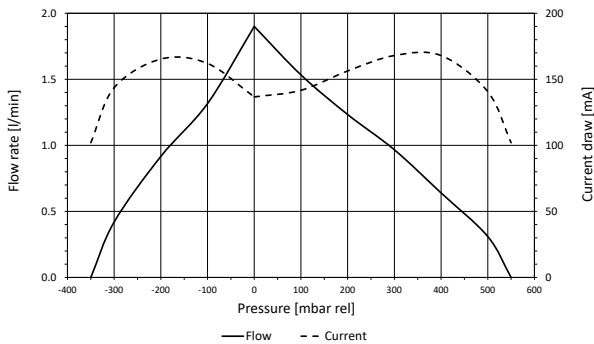

## NMP015.1.2XPDC-B 12V FLOW CURVE

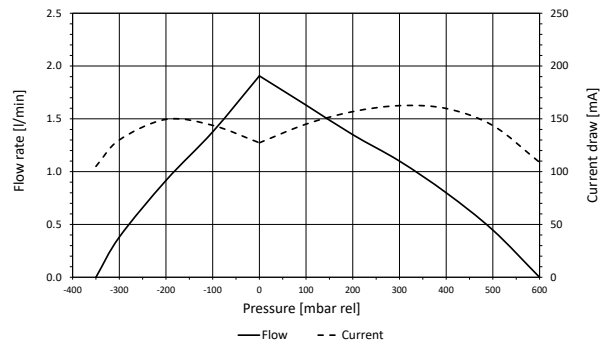

# NMP015.1.2XTDC-L

## PERFORMANCE DATA

Series model	Flow rate at atm. pressure (l/min)	Max. operating pressure (bar rel)	Ultimate vacuum (mbar abs.)
NMP015.1.2XTDC-L 6V	1.4	0.5	650
NMP015.1.2XTDC-L 12V	1.4	0.5	650

## NMP015.1.2XTDC-L

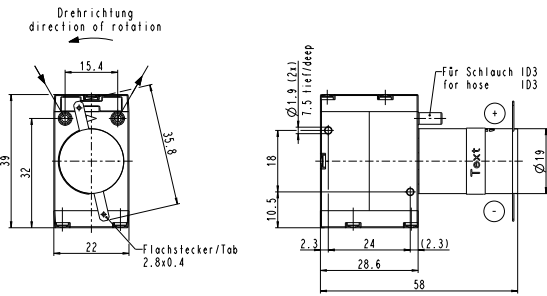

Dimensions in mm

# NMP015.1.2XTDC-B

## PERFORMANCE DATA

Series model	Flow rate at atm. pressure (l/min)	Max. operating pressure (bar rel)	Ultimate vacuum (mbar abs.)
NMP015.1.2XTDC-B 6V	1.5	0.5	650
NMP015.1.2XTDC-B 12V	1.5	0.5	650

## NMP015.1.2XTDC-B

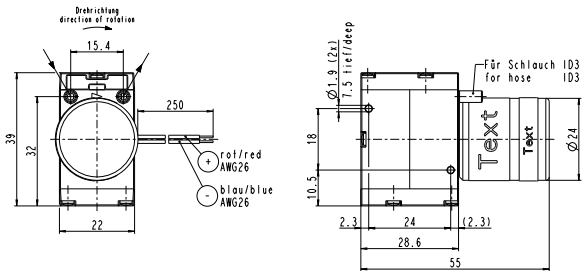

Dimensions in mm

## NMP015.1.2XTDC-L 6V FLOW CURVE

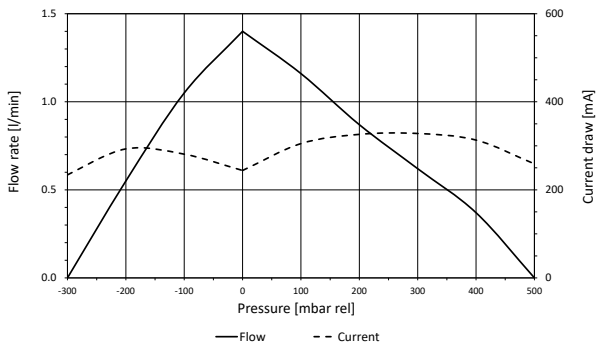

## NMP015.1.2XTDC-B 6V FLOW CURVE

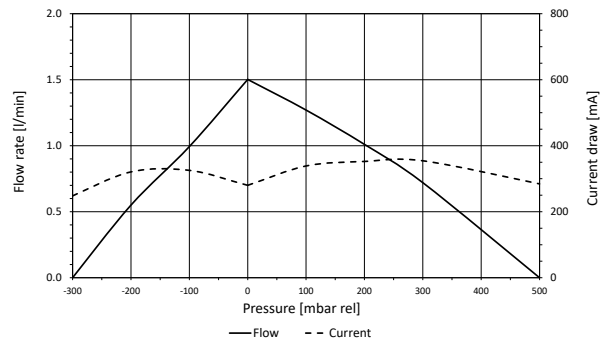

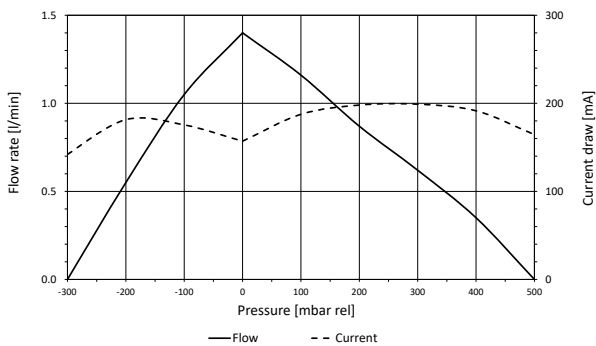

## NMP015.1.2XTDC-L 12V FLOW CURVE

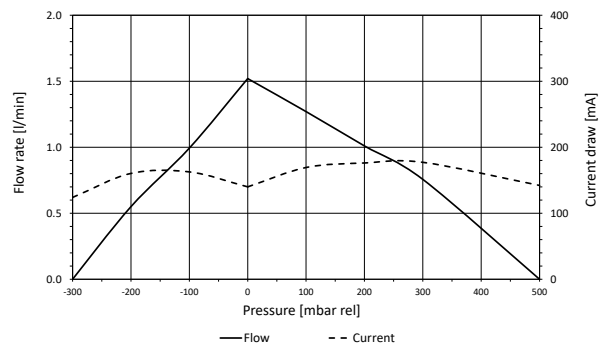

## NMP015.1.2XTDC-B 12V FLOW CURVE



OPTIONS			
Description	Illustration	Part No.	Details
Motors		On request	Other motors and voltages on request.
Eccentric		On request	Different eccentricities on request.

The performance values for the series models shown on this data sheet were determined under test conditions. The actual performance values may differ and depend in particular on the usage conditions and therefore on the specific application, on the parameters of the components involved in the user's system and on any technical modifications carried out which deviate from the standard configuration or the as delivered condition.

If individual designs have been created for specific customers on the basis of series models, other technical performance data may apply. Before operation begins, the relevant operating instructions and/or assembly or installation instructions should be read and the safety information contained in these instructions should be noted. KNF reserves the right to make changes to the product and the associated documentation without prior notice to the customer.



[www.knf.com](http://www.knf.com)